

# TRANSFORMERS



**AGES 5+**  
83678/83658 Ass't.



**WARNING:**

CHOKING HAZARD-Small parts.  
Not for children under 3 years.

TRANSFORMERS.COM

NOTE: Some parts are made to detach if excessive force is applied and are designed to be reattached if separation occurs. Adult supervision may be necessary for younger children.

## CHANGING TO VEHICLE

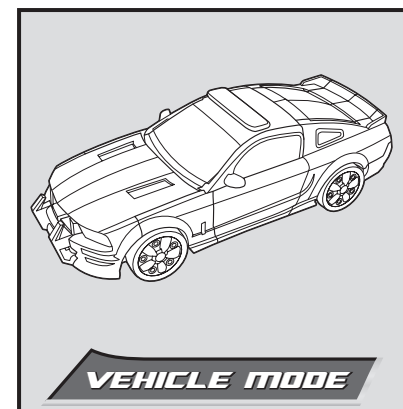
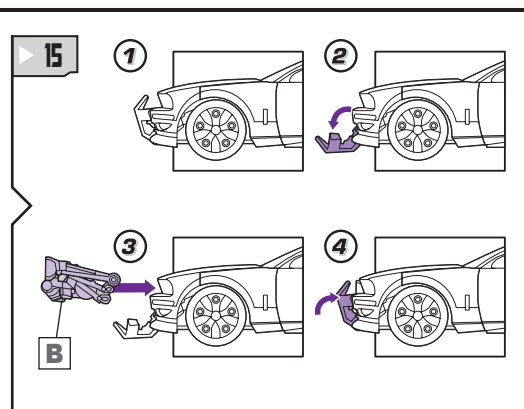
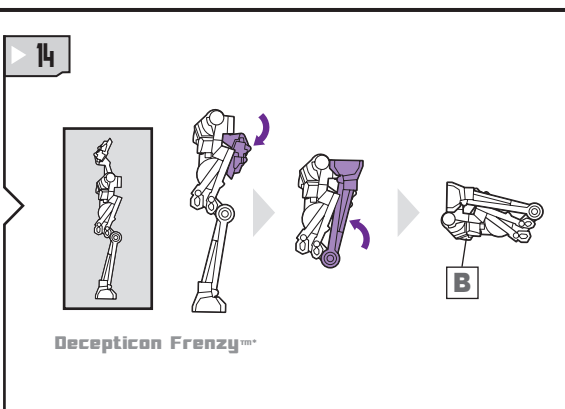
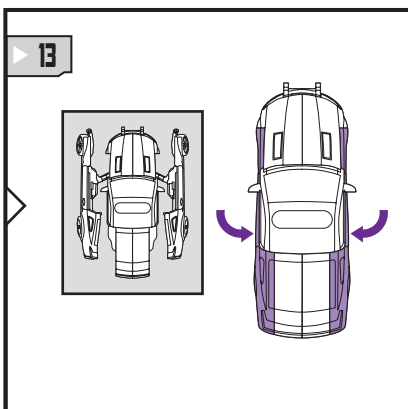
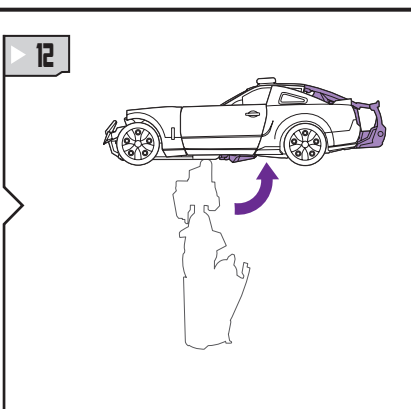
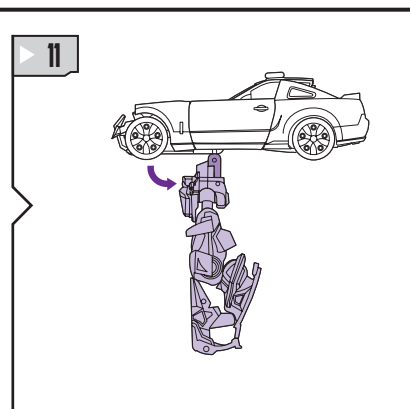
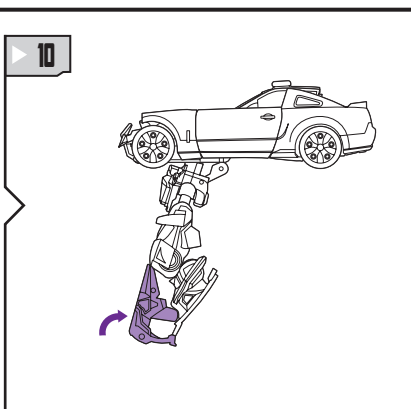
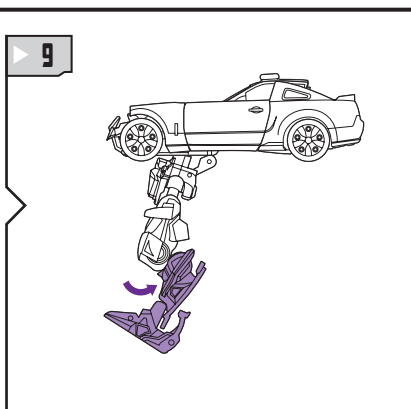
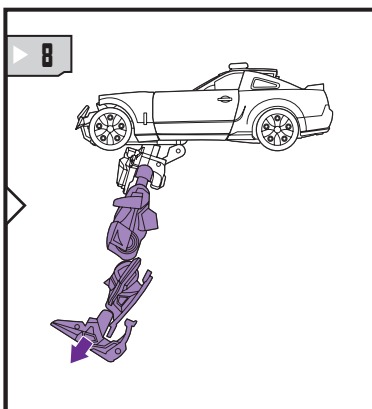
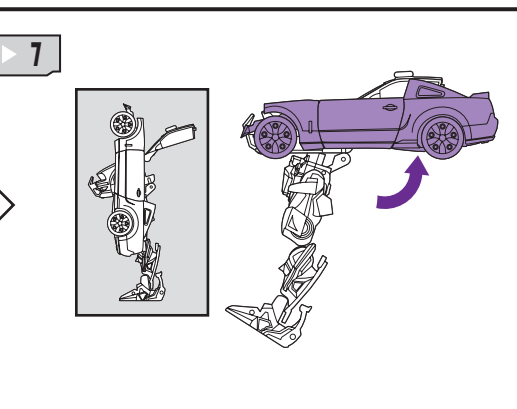
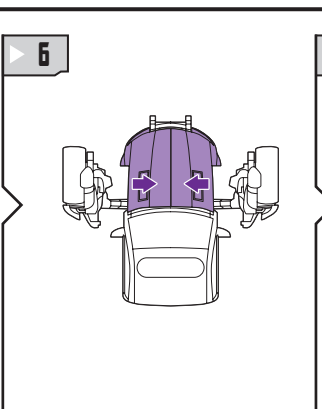
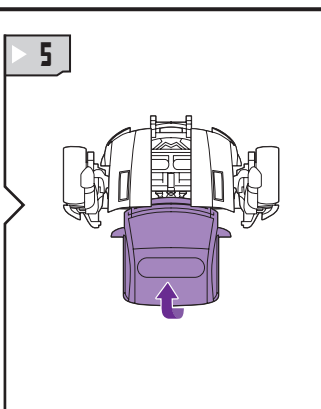
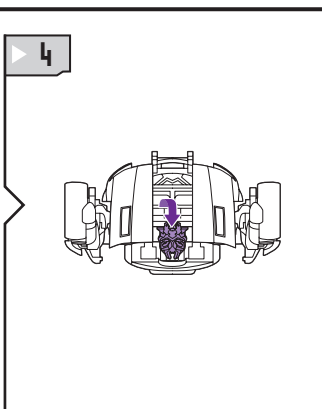
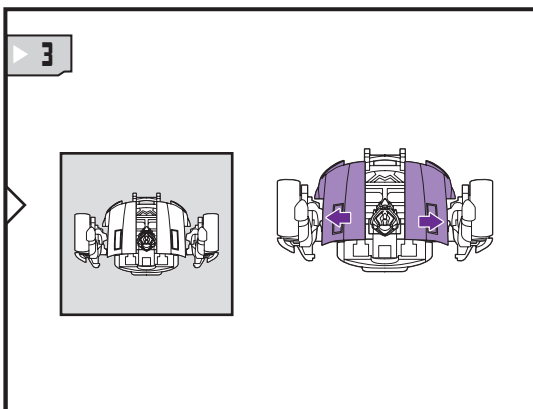
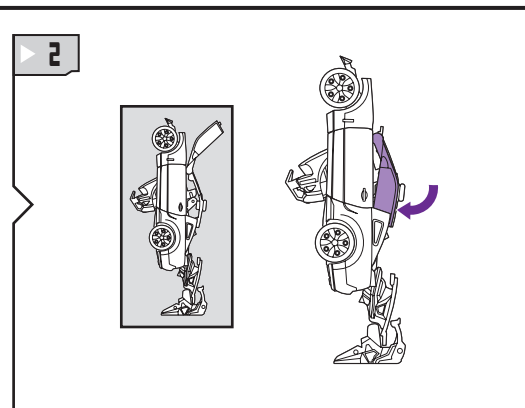
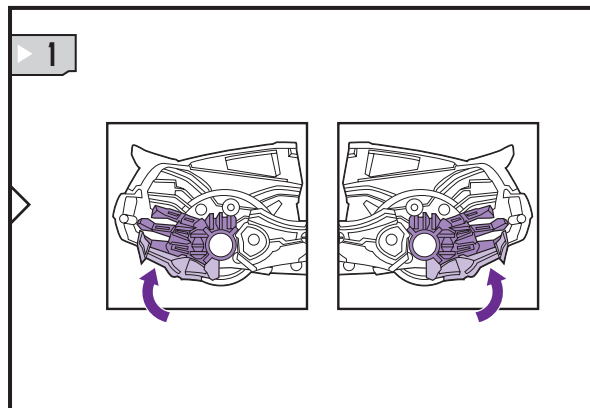
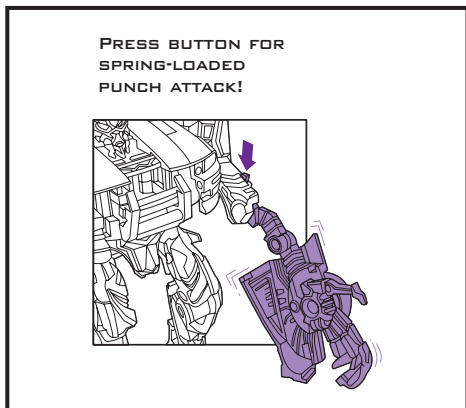
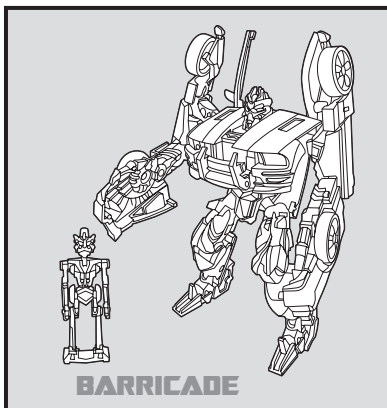

REVERSE ORDER OF INSTRUCTIONS  
TO CONVERT BACK INTO ROBOT.

TRANSFORMERS.COM

Some poses may require hand support.

P/N 6767690000



© 2007 DreamWorks LLC and Paramount Pictures Corporation  
® and/or TM & © 2007 Hasbro. All rights reserved.  
TM & © denote U.S. trademarks.  
Manufactured under license from Tomy Company, Ltd.



DREAMWORKS  
PICTURES



Not suitable for children  
under 3 years because of  
small parts - choking hazard.



Saleen® and S281 are  
registered trademarks  
of Saleen Inc. used  
under license.